

# SUPPLEMENTAL ANNEX – List of Assets

Wiltshire Council

Cabinet Capital Assets Committee

17<sup>th</sup> January 2017

## SITE DETAILS

### SITE 1.

Broad Hinton – Land adjoining Tom Gallagher Van Centre

UPRN – 07009S1

Location Plan – Site Extent Subject to Survey (Not to Scale)

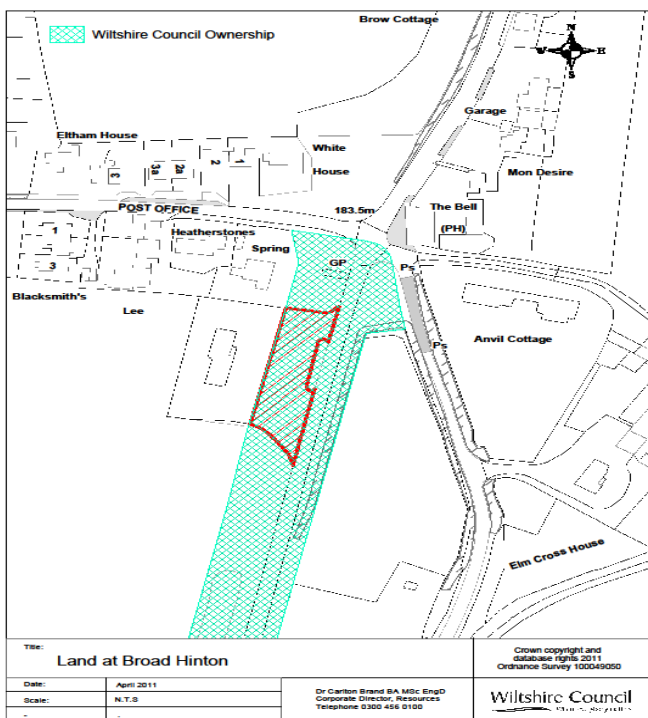



**SITE 3.**

**Tisbury - Former Youth Centre**

**Location Plan – Site Extent Subject to Survey (Not to Scale)**

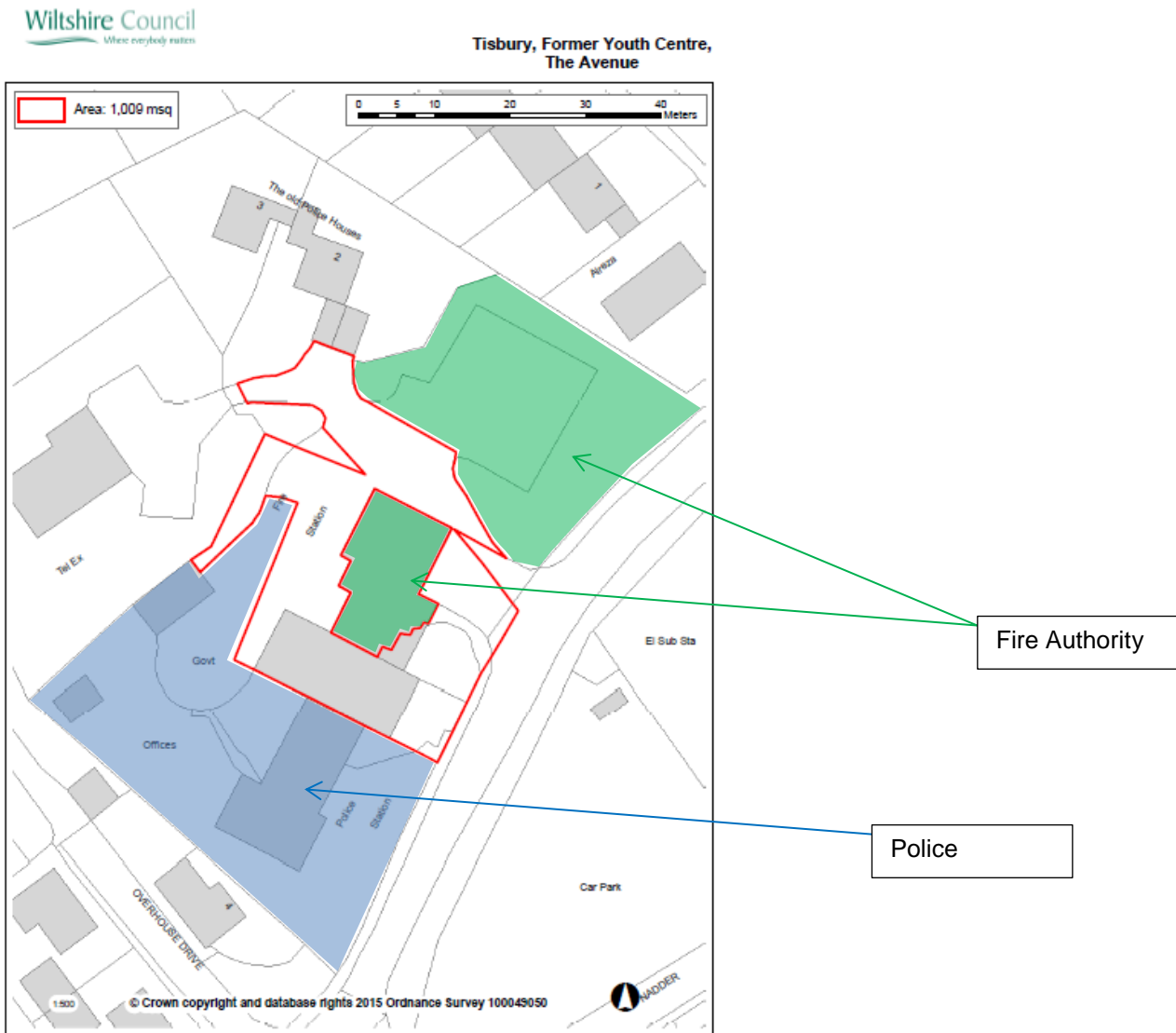

**SITE 4.**

**Trowbridge – Bradford Road Car Park**

**UPRN – 20317S2**

**Location Plan – Site Extent Subject to Survey (Not to Scale)**



**Trowbridge  
Bradford Road Car Pak**



**SITE 5.**

**Warminster – former Household Recycling Centre, Furnax Lane**

**UPRN – 01310S1**

**Location Plan – Site Extent Subject to Survey (Not to Scale)**

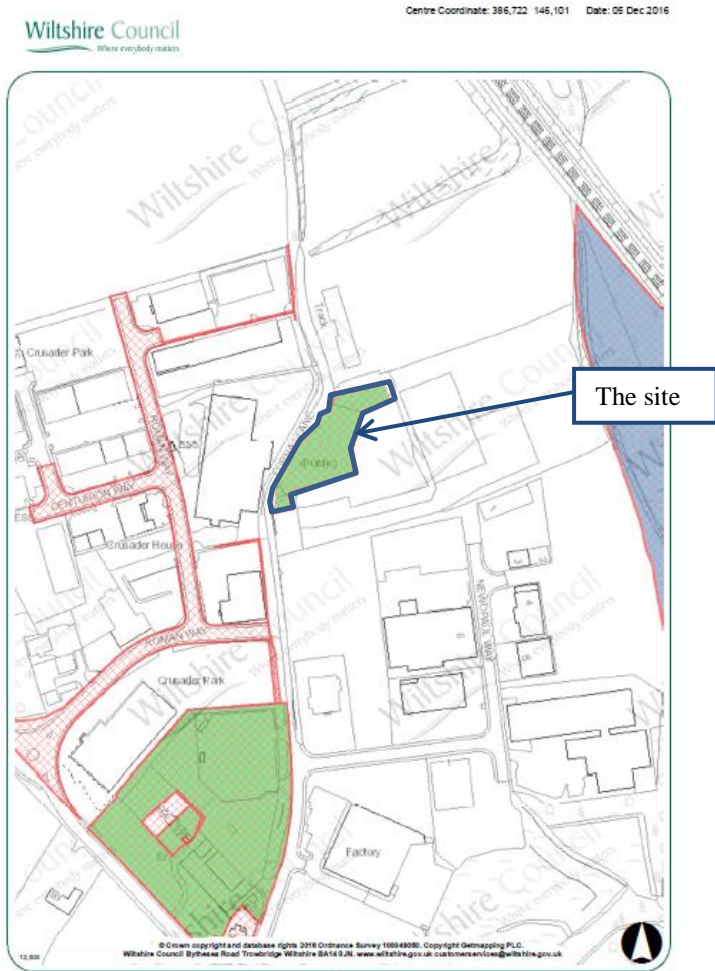

**SITE 6**

**2 Middle Lodge, Pewsham, Chippenham, Wiltshire, SN15 3QY**

**UPRN – 03046S8**

**Location Plan – Site Extent Subject to Survey (Not to Scale)**

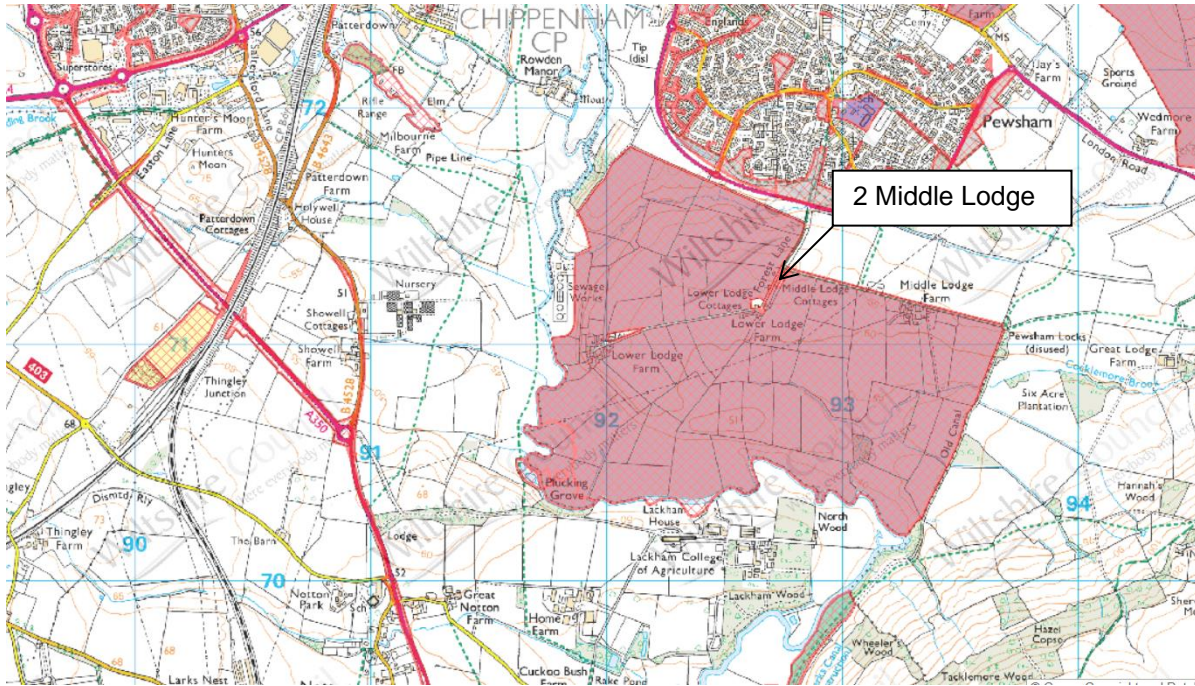

**SITE 7.**

**Corsham Railway Embankment, South Side – Parcel of land**

**UPRN – Part of 10125S1**

**Location Plan – site for transfer denoted by pink shading**

